

PLOT NO.	OWNER	LESSEE	OCCUPIER	REQUIREMENT	AREA OF LAND	COLOUR ON PLAN
1	Lingwood Estates (Chilton) Limited, Lion House, Red Lion Street, London WC1R 4GB (title no. ON230541)	LaFarge Tarmac Cement and Lime Limited, Portland House, Bickenhill Lane, Solihull, Birmingham, B37 7BQ (title no. ON256434)	Part Owner Part Lessee or underlessee	Title	23,880 sq. m. or thereabouts	Pink
2	Lingwood Estates (Chilton) Limited, Lion House, Red Lion Street, London WC1R 4GB (title no. ON230541)	None	Owner	Title	10,076 sq. m. or thereabouts	Pink
3	Helen Francine Shorhouse, 1 Sunbury Lane, Battersea, London, SW11 3NP Hilary Anne King-Thompson, Hilcote House, The Ridgeway, Boars Hill Oxfordshire OX1 5EZ (title no. ON193831)	None	Owner (part only)	Title	13,915 sq. m. or thereabouts	Pink
4	Helen Francine Shorhouse, 1 Sunbury Lane, Battersea, London, SW11 3NP Hilary Anne King-Thompson, Hilcote House, The Ridgeway, Boars Hill Oxfordshire OX1 5EZ (title no. ON193831)	None	Owner (part only)	Title	3,608 sq. m. or thereabouts	Pink
5	Helen Francine Shorhouse, 1 Sunbury Lane, Battersea, London, SW11 3NP Hilary Anne King-Thompson, Hilcote House, The Ridgeway, Boars Hill Oxfordshire OX1 5EZ (title no. ON193831)	None	Owner (part only)	Title	568 sq. m. or thereabouts	Pink
6	Helen Francine Shorhouse, 1 Sunbury Lane, Battersea, London, SW11 3NP Hilary Anne King-Thompson, Hilcote House, The Ridgeway, Boars Hill Oxfordshire OX1 5EZ (title no. ON193831)	None	Owner	Title	863 sq. m. or thereabouts	Pink
7	Lingwood Estates (Chilton) Limited, Lion House, Red Lion Street, London WC1R 4GB (title no. ON151279)	LaFarge Tarmac Cement and Lime Limited, Portland House, Bickenhill Lane, Solihull, Birmingham, B37 7BQ (title no. ON225405)	Lessee or underlessee	Title	146 sq. m. or thereabouts	Pink
8	Lingwood Estates (Chilton) Limited, Lion House, Red Lion Street, London WC1R 4GB (title no. ON151279)	LaFarge Tarmac Cement and Lime Limited, Portland House, Bickenhill Lane, Solihull, Birmingham, B37 7BQ (title no. ON225405)	Lessee or underlessee	Title	751 sq. m. or thereabouts	Pink
9	Lingwood Estates (Chilton) Limited, Lion House, Red Lion Street, London WC1R 4GB (title no. ON151279)	LaFarge Tarmac Cement and Lime Limited, Portland House, Bickenhill Lane, Solihull, Birmingham, B37 7BQ (title no. ON225405)	Lessee or underlessee	Title	257 sq. m. or thereabouts	Pink
10	Lingwood Estates (Chilton) Limited, Lion House, Red Lion Street, London WC1R 4GB (title no. ON230541)	None	Owner	Rights	3,646 sq. m. or thereabouts	Blue
11	Helen Francine Shorhouse, 1 Sunbury Lane, Battersea, London, SW11 3NP Hilary Anne King-Thompson, Hilcote House, The Ridgeway, Boars Hill Oxfordshire OX1 5EZ (title no. ON193831)	None	Owner	Rights	9,295 sq. m. or thereabouts	Blue
12	Gerald Howard King and Ismay Agnes King, South Lodge, Boars Hill, Oxford (title no. ON147487)	None	Owner	Landscape	1,657 sq. m. or thereabouts	Green
13	Gerald Howard King and Ismay Agnes King, South Lodge, Boars Hill, Oxford Hilary Anne King-Thompson, Hilcote House, The Ridgeway, Boars Hill, Oxfordshire OX1 5EZ and Helen Francine Shorhouse, 1 Sunbury Lane, Battersea, London, SW11 3NP (title no. BK71871)	None	Owner	Landscape	3,123 sq. m. or thereabouts	Green
14	Lingwood Estates (Chilton) Limited, Lion House, Red Lion Street, London WC1R 4GB (title no. ON230541)	None	Owner	Title	1,064 sq. m. or thereabouts	Pink
15	Lingwood Estates (Chilton) Limited, Lion House, Red Lion Street, London WC1R 4GB	None	None	Title	1,410 sq. m. or thereabouts	Pink
16	Gerald Howard King and Ismay Agnes King, South Lodge, Boars Hill, Oxford	None	None	Title	833 sq. m. or thereabouts	Pink
17	Gerald Howard King and Ismay Agnes King, South Lodge, Boars Hill, Oxford Hilary Anne King-Thompson, Hilcote House, The Ridgeway, Boars Hill, Oxfordshire OX1 5EZ and Helen Francine Shorhouse, 1 Sunbury Lane, Battersea, London, SW11 3NP	None	None	Title	74 sq. m. or thereabouts	Pink

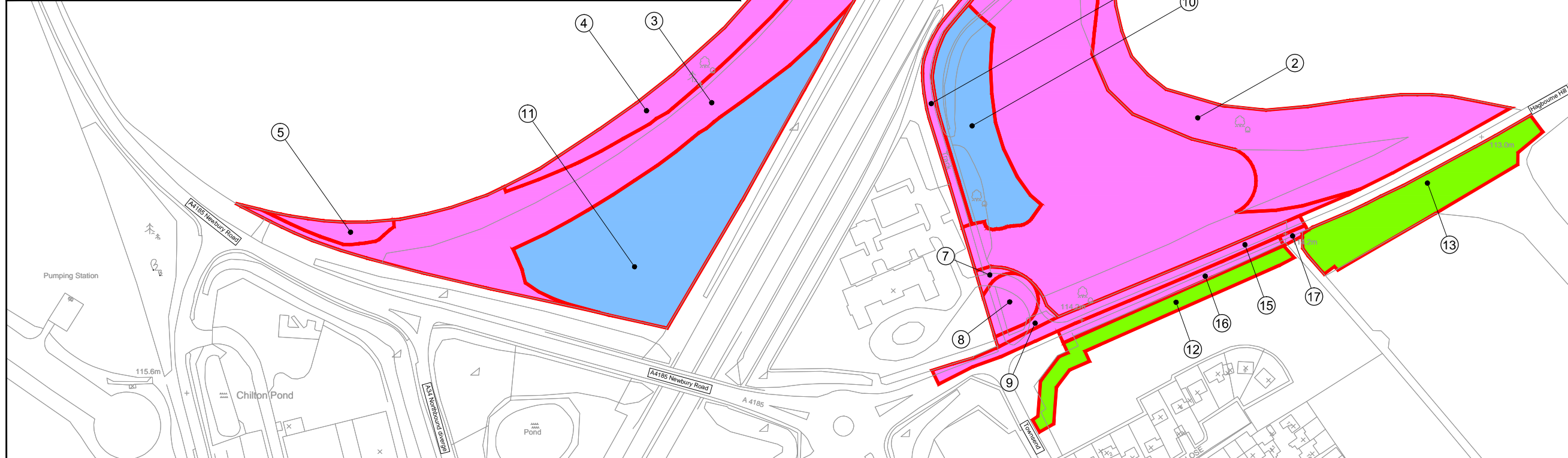
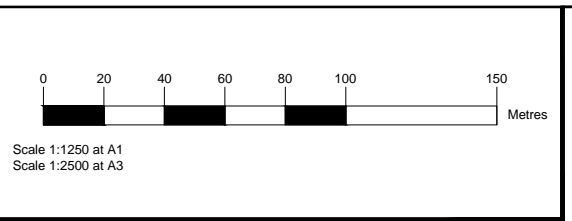

Drawing No. S-5123398/FEA/000/017		Revision 2																																																									
<p>Reproduced from the Ordnance Survey mapping with the permission of the Controller of Her Majesty's Stationery Office © Crown Copyright. Unauthorised reproduction infringes Crown Copyright, and may lead to prosecution or civil proceedings. Oxfordshire County Council Licence No 100023343</p> <table border="1"> <thead> <tr> <th>Rev.</th> <th>Date</th> <th>Purpose of revision</th> <th>Drawn</th> <th>Checked</th> <th>Approved</th> </tr> </thead> <tbody> <tr> <td>0</td> <td>-</td> <td>ORIGINAL ISSUE</td> <td>SEE</td> <td>TITLE</td> <td>BLOCK</td> </tr> <tr> <td>1</td> <td>27/03/14</td> <td>BOUNDARY UPDATE</td> <td>JAV</td> <td>DJG</td> <td>DJG</td> </tr> <tr> <td>2</td> <td>03/04/14</td> <td>PLOTS 14 TO 17 ADDED</td> <td>JAV</td> <td>DJG</td> <td>DJG</td> </tr> </tbody> </table> <p>Steve Howell Deputy Director of Environment & Economy Oxfordshire County Council Speedwell House Speedwell Street Oxford OX1 1NE Tel: (01865) 815700 Fax: (01865) 241577</p> <p>Project title OXFORDSHIRE COUNTY COUNCIL CHILTON NORTH FACING SLIPS FEASIBILITY</p> <p>Drawing title LAND INTEREST PLAN</p> <table border="1"> <tr> <td colspan="4">Drawing Status</td> </tr> <tr> <td>Scale @ A1</td> <td>1:1250</td> <td>Drawn by</td> <td>DK</td> <td>Checked by</td> <td>JAV</td> <td>Approved by</td> <td>DJG</td> </tr> <tr> <td>Scale @ A3</td> <td>1:2500</td> <td>Date drawn</td> <td>03/12/13</td> <td>Date checked</td> <td>24/01/14</td> <td>Date approved</td> <td>24/01/14</td> </tr> <tr> <td colspan="4">Oxfordshire Project No & File Ref</td> <td colspan="4">S-5123398</td> </tr> <tr> <td colspan="2">Drawing No. S-5123398/FEA/000/017</td> <td colspan="2">Revision 2</td> </tr> </table>				Rev.	Date	Purpose of revision	Drawn	Checked	Approved	0	-	ORIGINAL ISSUE	SEE	TITLE	BLOCK	1	27/03/14	BOUNDARY UPDATE	JAV	DJG	DJG	2	03/04/14	PLOTS 14 TO 17 ADDED	JAV	DJG	DJG	Drawing Status				Scale @ A1	1:1250	Drawn by	DK	Checked by	JAV	Approved by	DJG	Scale @ A3	1:2500	Date drawn	03/12/13	Date checked	24/01/14	Date approved	24/01/14	Oxfordshire Project No & File Ref				S-5123398				Drawing No. S-5123398/FEA/000/017		Revision 2	
Rev.	Date	Purpose of revision	Drawn	Checked	Approved																																																						
0	-	ORIGINAL ISSUE	SEE	TITLE	BLOCK																																																						
1	27/03/14	BOUNDARY UPDATE	JAV	DJG	DJG																																																						
2	03/04/14	PLOTS 14 TO 17 ADDED	JAV	DJG	DJG																																																						
Drawing Status																																																											
Scale @ A1	1:1250	Drawn by	DK	Checked by	JAV	Approved by	DJG																																																				
Scale @ A3	1:2500	Date drawn	03/12/13	Date checked	24/01/14	Date approved	24/01/14																																																				
Oxfordshire Project No & File Ref				S-5123398																																																							
Drawing No. S-5123398/FEA/000/017		Revision 2																																																									

- KEY:**
- Existing Highway Boundary
 - Proposed Highway Boundary
 - Licence Area for Working
- Edward Thomas Ivor Eyston of The Hendred Estate Office, High Street, East Hendred, Wantage, Oxfordshire, OX12 5JZ
 - John Mackenzie Watson and Susan Elizabeth Watson of Bramley House, Featherbed Lane, East Hendred, Wantage, Oxon
 - Leo John Edwards and Jennifer Mary Edwards of The Lodge, Steventon House Hotel, Milton Hill, Oxfordshire, OX13 6AB
 - Sanjeet Gill of Steventon House Hotel, Milton Hill, Steventon, Abingdon, Oxfordshire
 - Martin John Griffiths and Melanie Suzanne Griffiths of Plough Farm, Old Road, East Hendred, Wantage, Oxon
 - Alan Richard Binning and Caroline Audrey Binning of Hill Farm, Steventon, Abingdon, Oxon
 - Robin Herd Limited of Massetts, Milton Hill, Abingdon, Oxon
 - Alan Richard Binning and Patrick Rossington Gale and Christine Mary Gale of Hill Farm, Steventon, Abingdon, Oxon and Manor Farm, Appleford, Abingdon, Oxon
 - Patrick Rossington Gale and Christine Mary Gale of Manor Farm, Appleford, Abingdon, Oxon
 - William Earnest Clark of Greensands, Reading Road, East Hendred, Wantage, Oxon, OX12 8JE
 - Leslie Wells of Greensands, Reading Road, East Hendred, Wantage, Oxon, OX12 8JE
 - Trevor Payne of Bomar, Wantage Road, Great Shefford, Berks
 - John Charles Morris and Maria Teresa Josephine Wright of Sign Post Cottage, Milton Hill, Steventon, Abingdon, Oxfordshire, OX13 6AB
 - Rowan Napper and Katie Napper of Inghams Farm, West Hagbourne, Didcot, Oxfordshire, OX11 0NT
 - Esso Petroleum Company Limited, ExxonMobil House, Ermyn Way, Leatherhead, Surrey, KT22 8UX
 - Robert John Herd and Diane Mavis Herd of The Brew Tower, 33 Coopers Lane, Abingdon, Oxon, OX14 5GU
 - Infineum UK Limited, PO Box 1, Milton Hall, Abingdon, Oxon, OX13 6BB

VIEWPORT 1

VIEWPORT 2

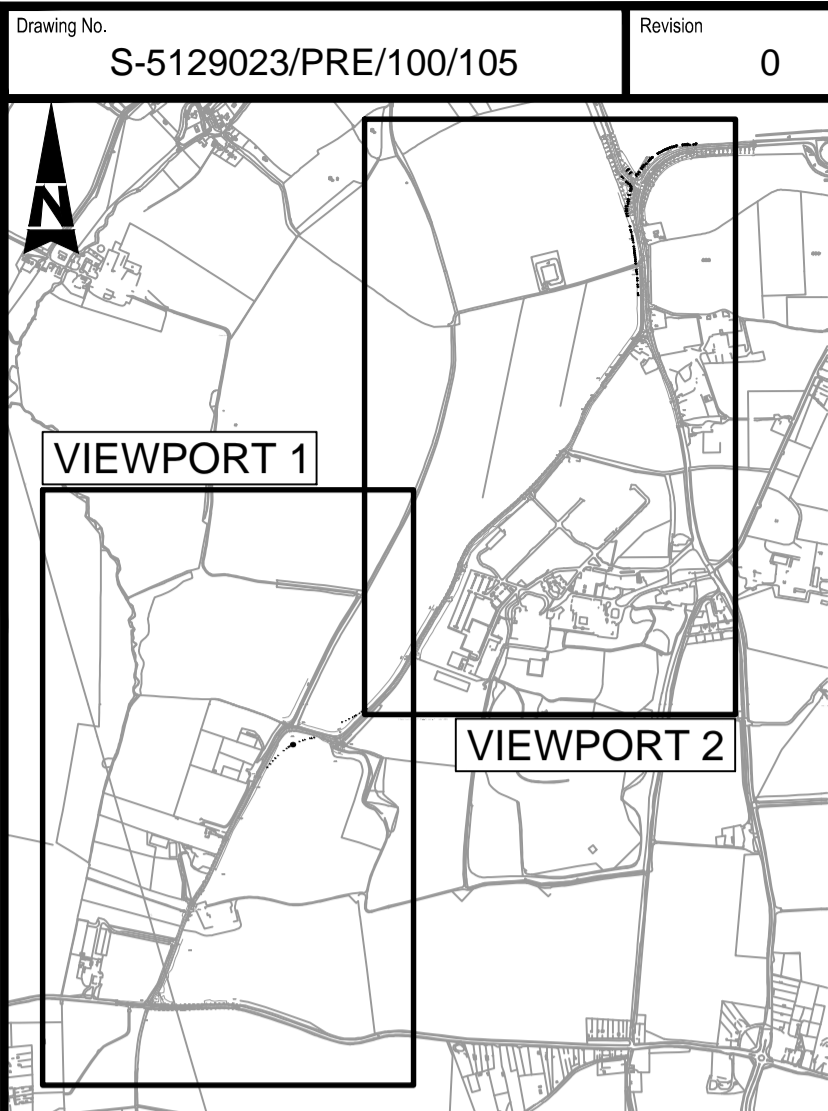
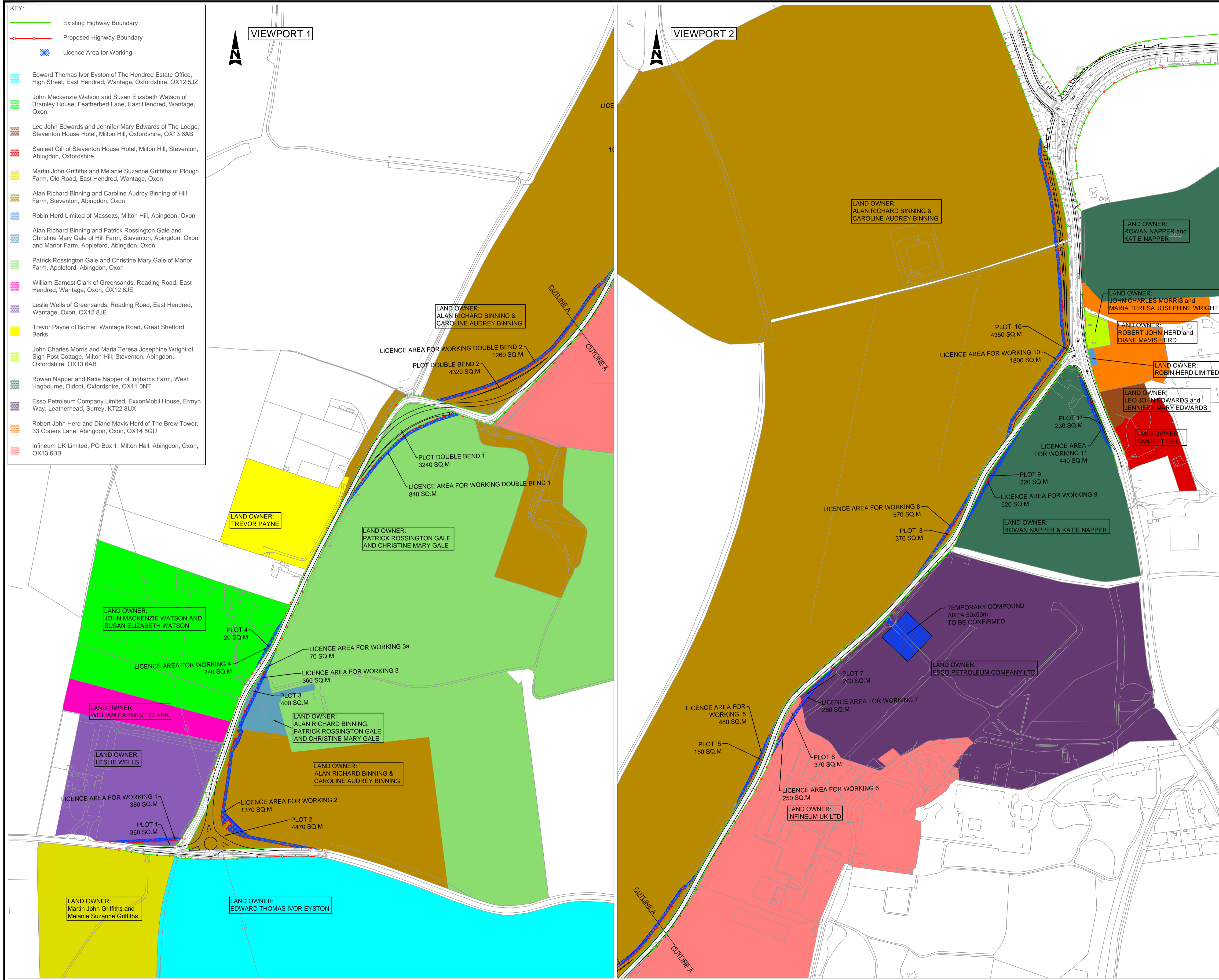

Rev.	Date	Purpose of revision	Drawn	Checked	Approved
0	-	ORIGINAL ISSUE	SEE	TITLE	BLOCK

Reproduced from the Ordnance Survey mapping with the permission of the Controller of Her Majesty's Stationery Office © Crown Copyright. Unauthorised reproduction infringes Crown Copyright, and may lead to prosecution or civil proceedings. Oxfordshire County Council Licence No 100023343

SAFETY, HEALTH AND ENVIRONMENTAL INFORMATION

IN ADDITION TO THE HAZARDS/RISKS NORMALLY ASSOCIATED WITH THE TYPES OF WORK DETAILED ON THIS DRAWING, NOTE THE FOLLOWING SIGNIFICANT RESIDUAL RISKS

CONSTRUCTION	NONE
MAINTENANCE/CLEANING	NONE
USE	NONE
DECOMMISSIONING/DEMOLITION	NONE

Rev.	Date	Purpose of revision	Drawn	Checked	Approved
0	-	ORIGINAL ISSUE	SEE	TITLE	BLOCK

OXFORDSHIRE COUNTY COUNCIL
 Mark Kemp
 Deputy Director - Commercial
 Environment & Economy
 Oxfordshire County Council
 Speedwell House
 Speedwell Street
 Oxford
 OX1 1NE
 Tel: (01865) 815700
 Fax: (01865) 241577

Project title
 OXFORDSHIRE COUNTY COUNCIL
 FEATHERBED LANE AND STEVENTON LIGHTS
 IMPROVEMENTS

Drawing title
 COMPOSITE LAND
 OWNERSHIP PLAN

Drawing Status				FOR INFORMATION			
Scale @ A1	Drawn by	Checked by	Approved by	Scale @ A1	Drawn by	Checked by	Approved by
1:2500	RP	SRH	AL	1:2500	RP	SRH	AL
Date drawn	Date checked	Date checked	Date approved	Date drawn	Date checked	Date checked	Date approved
11/12/14	11/12/14	11/12/14	11/12/14	11/12/14	11/12/14	11/12/14	11/12/14
Oxfordshire Project No & File Ref				5129023			
Drawing No.				S-5129023/PRE/100/105			
Revision				0			

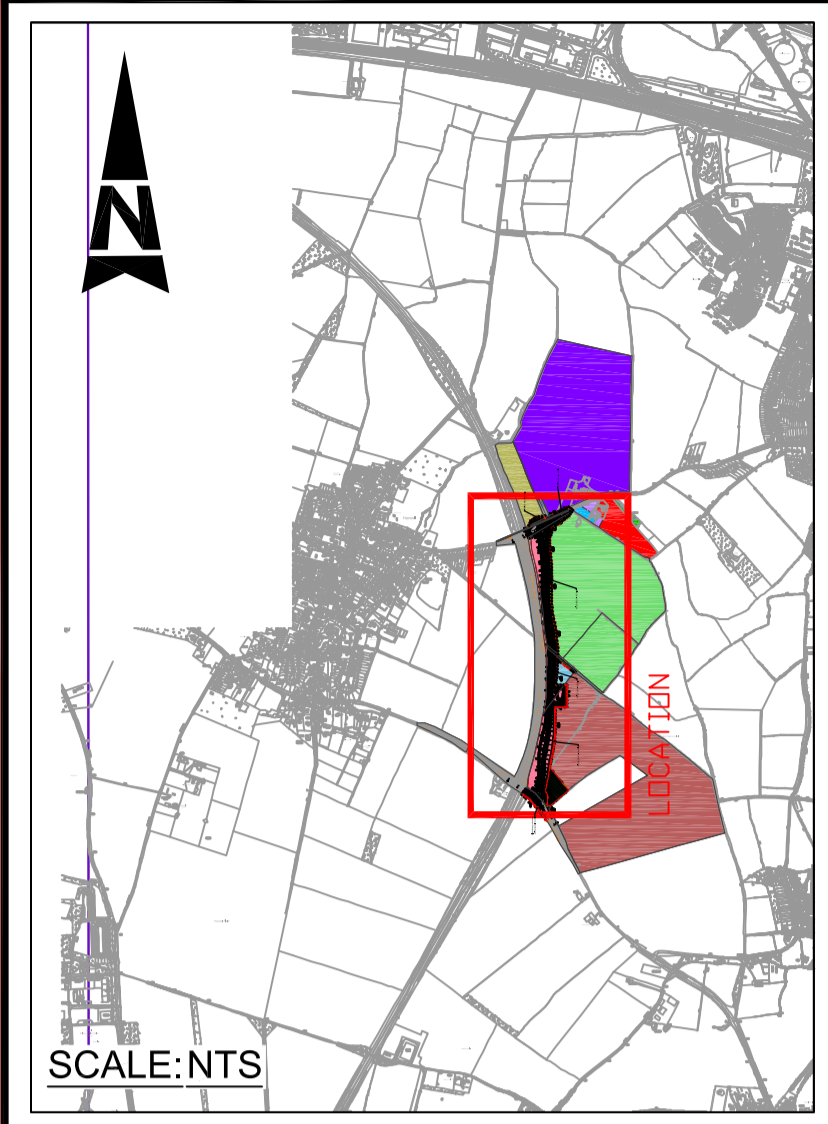
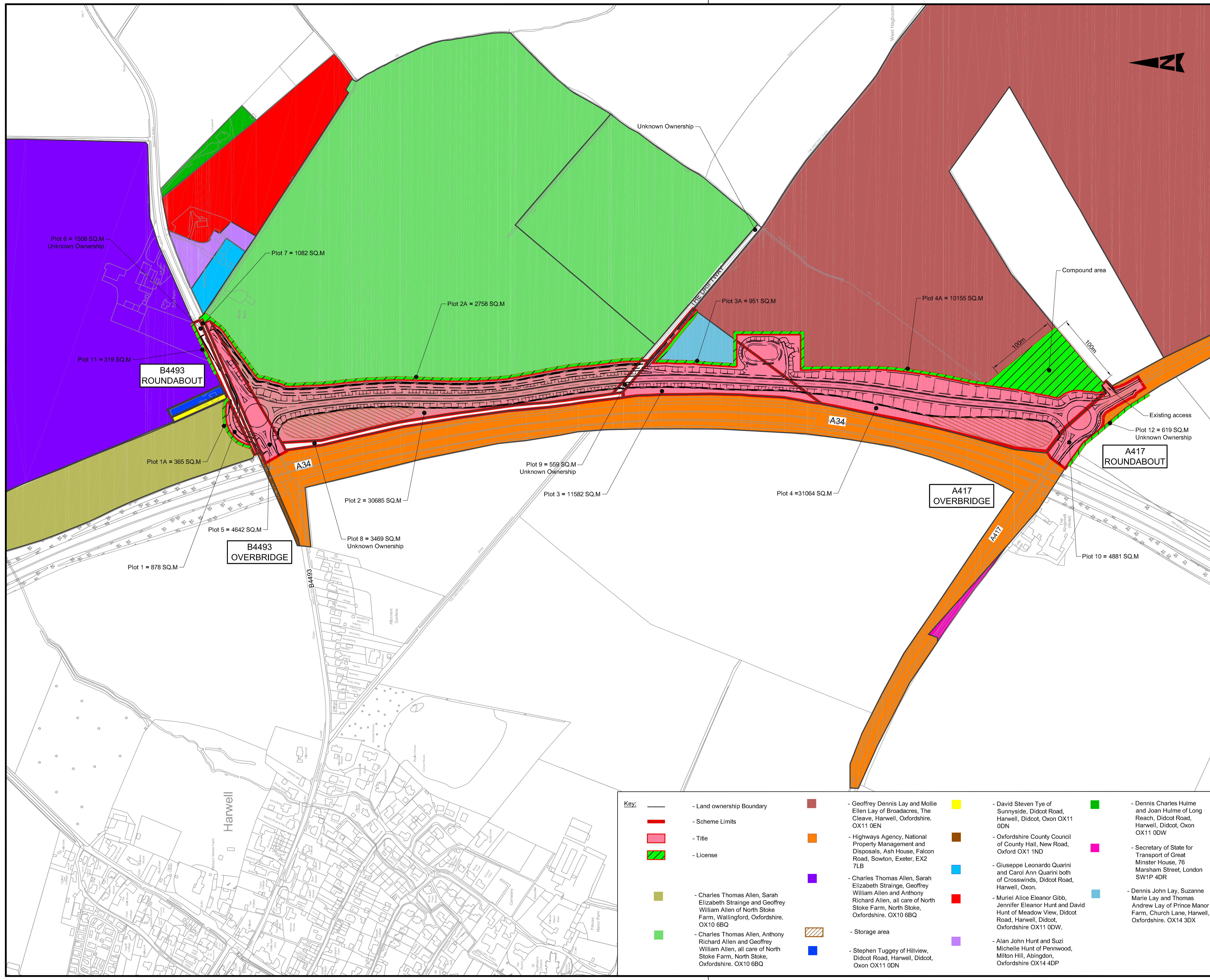

Notes:
 1. Land ownership boundary is based on the Land Registry plan drawing (S-000494/F1700/001) supplied by OCC and Land Registry plans.

SAFETY, HEALTH AND ENVIRONMENTAL INFORMATION

IN ADDITION TO THE HAZARDS/RISKS NORMALLY ASSOCIATED WITH THE TYPES OF WORK DETAILED ON THIS DRAWING, NOTE THE FOLLOWING SIGNIFICANT RESIDUAL RISKS

CONSTRUCTION	NONE
MAINTENANCE/CLEANING	NONE
USE	NONE
DECOMMISSIONING/DEMOLITION	NONE

Reproduced from the Ordnance Survey mapping with the permission of the Controller of Her Majesty's Stationery Office © Crown Copyright. Unauthorised reproduction infringes Crown Copyright, and may lead to prosecution or civil proceedings. Oxfordshire County Council Licence No LA076805

Rev.	Date	Purpose of revision	Drawn	Checked	Approved
0	21/02/14	ORIGINAL ISSUE	MN	BB	PM
1	05/03/14	ALIGNMENT DESIGN AMENDED	MN	BB	PM
2	27/03/14	COMPOUND / STORAGE AREAS ADDED	MN	BB	PM
3	15/05/14	AREAS ADDED, BOUNDARY AMENDED	JSE	BB	PM
4	08/09/14	UPDATED ALIGNMENT AND LAND OWNERSHIP AREAS ADDED	AM	KL	BB
5	26/09/14	LICENSE AREAS ADDED	AM	KL	BB

Mark Kemp
 Deputy Director - Commercial
 Environment and Economy
 Oxfordshire County Council
 Speedwell House
 Speedwell Street
 Oxford
 OX1 1NE
 Tel: (01865) 815700
 Fax: (01865) 241577

Project title
 HARWELL LINK ROAD (B4493 to A417)

Drawing title
 HARWELL LINK ROAD (B4493 to A417)
 LAND REFERENCE PLAN
 AND PROPOSED ALIGNMENT

Drawing Status
PRELIMINARY DESIGN

Scale @ A1
 1:2500
 Date drawn: 21/02/2014
 Date checked: 21/02/2014
 Date approved: 21/02/2014

Key:

	- Land ownership Boundary		- Scheme Limits		- Title		- License		- Geoffrey Dennis Lay and Mollie Ellen Lay of Broadacres, The Cleave, Harwell, Oxfordshire, OX11 0EN		- David Steven Tye of Sunnyside, Didcot Road, Harwell, Didcot, Oxon OX11 0DN		- Dennis Charles Hulme and Joan Hulme of Long Reach, Didcot Road, Harwell, Didcot, Oxon OX11 0DW
	- Charles Thomas Allen, Sarah Elizabeth Straince and Geoffrey William Allen of North Stoke Farm, Wallingford, Oxfordshire, OX10 6BQ		- Highways Agency, National Property Management and Disposals, Ash House, Falcon Road, Sowton, Exeter, EX2 7LB		- Giuseppe Leonardo Quarini and Carol Ann Quarini both of Crosswinds, Didcot Road, Harwell, Oxon.		- Charles Thomas Allen, Sarah Elizabeth Straince, Geoffrey William Allen and Anthony Richard Allen, all care of North Stoke Farm, North Stoke, Oxfordshire, OX10 6BQ		- Storage area		- Muriel Alice Eleanor Gibb, Jennifer Eleanor Hunt and David Hunt of Meadow View, Didcot Road, Harwell, Didcot, Oxfordshire OX11 0DW.		- Secretary of State for Transport of Great Minster House, 76 Marsham Street, London SW1P 4DR
	- Charles Thomas Allen, Anthony Richard Allen and Geoffrey William Allen, all care of North Stoke Farm, North Stoke, Oxfordshire, OX10 6BQ		- Stephen Tuggey of Hillview, Didcot Road, Harwell, Didcot, Oxon OX11 0DN		- Alan John Hunt and Suzi Michelle Hunt of Pennwood, Milton Hill, Abingdon, Oxfordshire OX14 4DP		- Dennis John Lay, Suzanne Marie Lay and Thomas Andrew Lay of Prince Manor Farm, Church Lane, Harwell, Oxfordshire, OX14 3DX						



- KEY**
- Existing Highway Boundary
 - Proposed Highway Boundary
 - Licence Areas for Working
 - Christopher Frederick Lay and Nicholas Geoffrey Lay, Manor Farm, West Hagbourne, Oxfordshire
 - Christopher Frederick Lay and Nicholas Geoffrey Lay and Susan Elizabeth Lay and Margaret Bridget Lay
 - The Official Custodian for Charities of Hamsworth House.
 - Thames Water Utilities Limited (Co.Regn. No. 02366661)
 - Rowan Patrick Napper
 - Edna Alice Napper, Trevor John Pegram and Philip John Pocock.
 - Sheffield Flooring Limited (Co. Regn. No. 01544044).

Reproduced from the Ordnance Survey mapping with the permission of the Controller of Her Majesty's Stationery Office © Crown Copyright. Unauthorised reproduction infringes Crown Copyright, and may lead to prosecution or civil proceedings. Oxfordshire County Council Licence No 100023343

SAFETY, HEALTH AND ENVIRONMENTAL INFORMATION

IN ADDITION TO THE HAZARDS/RISKS NORMALLY ASSOCIATED WITH THE TYPES OF WORK DETAILED ON THIS DRAWING, NOTE THE FOLLOWING SIGNIFICANT RESIDUAL RISKS

CONSTRUCTION	MAINTENANCE/CLEANING	USE	DECOMMISSIONING/DEMOLITION
NONE	NONE	NONE	NONE

Rev.	Date	Purpose of revision	Drawn	Checked	Approved
0		ORIGINAL ISSUE	SEE	TITLE	BLOCK

Mark Kemp
Deputy Director - Commercial
Environment & Economy
Oxfordshire County Council
Speedwell House
Speedwell Street
Oxford
OX1 1NE
Tel: (01865) 815700
Fax: (01865) 241577

Project title
OXFORDSHIRE COUNTY COUNCIL
HARWELL LINK ROAD SECTION 2
(HAGBOURNE HILL)

Drawing title
COMPOSITE LAND
OWNERSHIP PLAN

Drawing Status FOR INFORMATION

Scale @ A1	Drawn by	Checked by	Approved by
1:5000	CW	SRH	AL

Date drawn 11/12/14 Date checked 11/12/14 Date approved 11/12/14

Oxfordshire Project No & File Ref 5129022

Drawing No. S-5129022/PRE/100/081 Revision 0

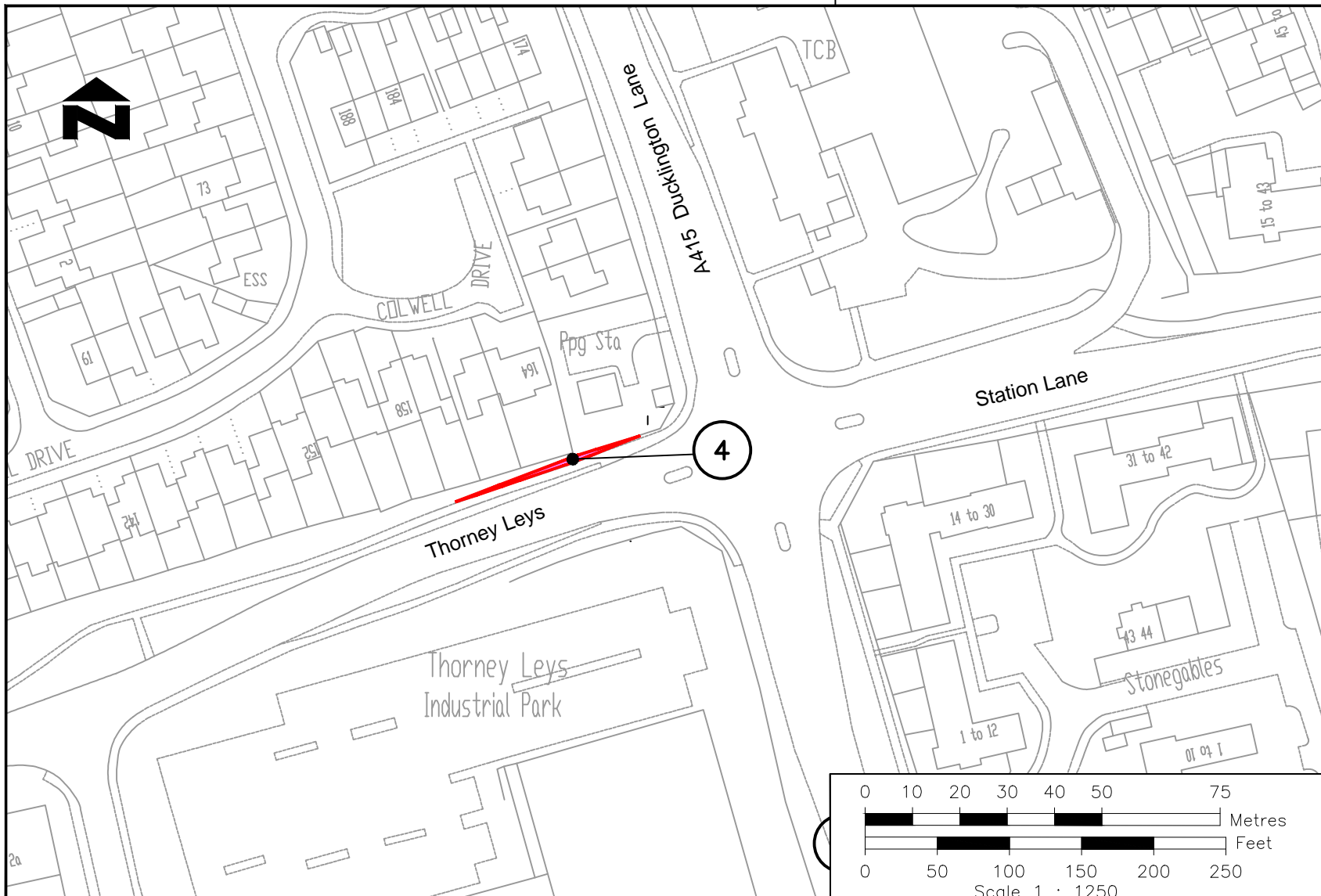

Drawing No. S-000924/PRE/000/017 Revision 0

Reproduced from the Ordnance Survey mapping with the permission of the Controller of Her Majesty's Stationery Office © Crown Copyright. Unauthorised reproduction infringes Crown Copyright, and may lead to prosecution or civil proceedings. Oxfordshire County Council Licence No LA076805

Rev.	Date	Purpose of revision	Drawn	Checked	Approved
0	DEC 13	Original drawing	AG	AG	PT

OXFORDSHIRE COUNTY COUNCIL
 Mark Kemp
 Deputy Director - Commercial Environment and Economy
 Oxfordshire County Council
 Speedwell House
 Speedwell Street
 Oxford
 OX1 1NE
 Tel: (01865) 815700
 Fax: (01865) 241577

Project title
A415 Ducklington Lane Corridor Highway Improvements

Drawing title
Land Interest Plan Plot 4

Drawing Status: For Information

Scale @ A4	Drawn by	Checked by	Approved by
1/1250	AG	PT	PT
	Date drawn Dec 2013	Date checked Dec 2013	Date approved Jan 2014

Oxfordshire Project No. & File Ref. S-000924
 Drawing No. S-000924/PRE/000/017 Revision 0

PLOT No.	OWNER	LESSEE	OCCUPIER	REQUIREMENT	AREA OF LAND	COLOUR ON PLAN
4	Westbury Homes (Sevenside) Ltd Persimmon House Fulford York.YO19 4FE			Title	25.0 sq. m.	Pink
	Abbey Homesteads Group Ltd.			Title	25.0 sq. m.	Pink

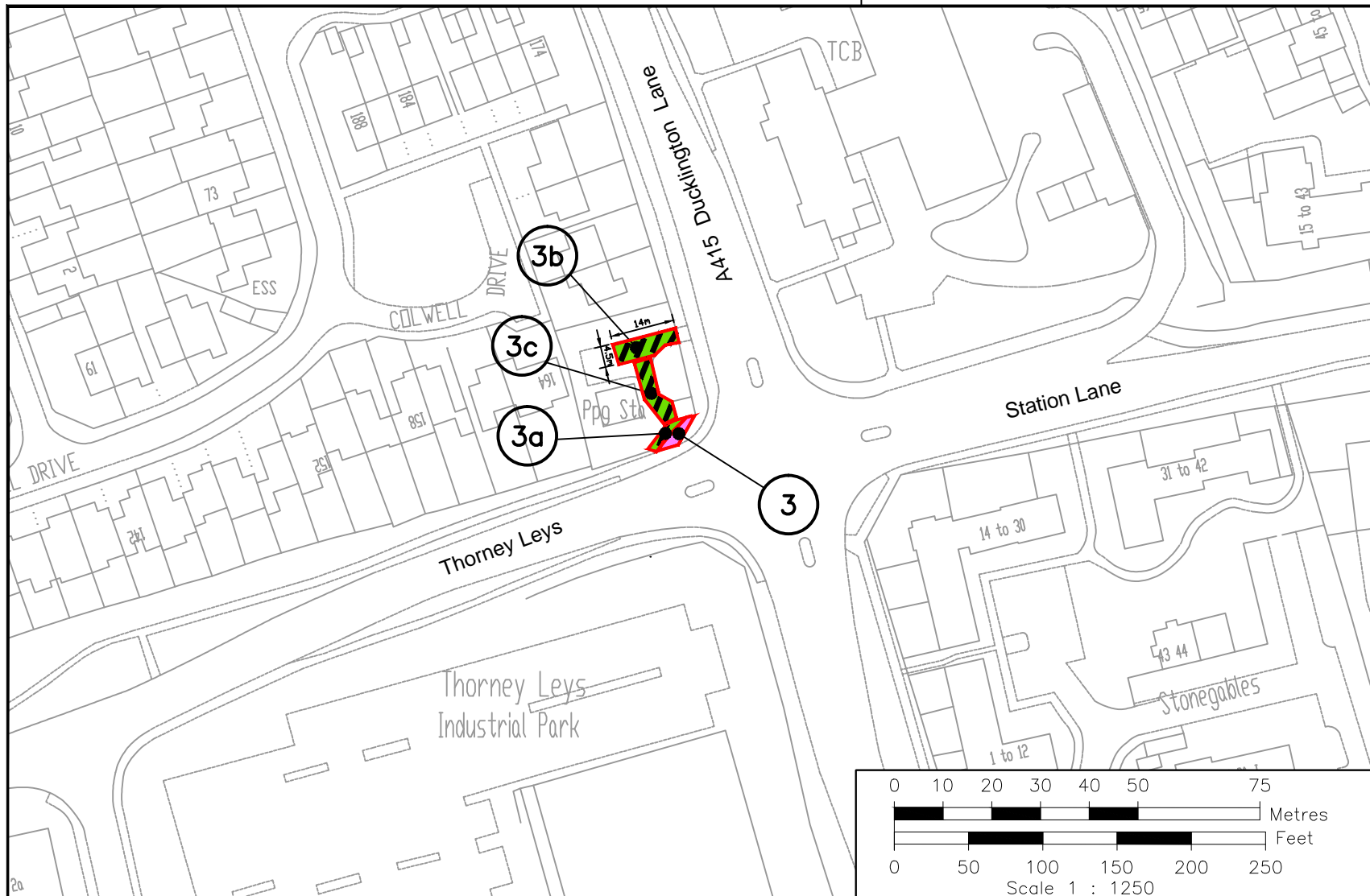

Reproduced from the Ordnance Survey mapping with the permission of the Controller of Her Majesty's Stationery Office © Crown Copyright. Unauthorised reproduction infringes Crown Copyright, and may lead to prosecution or civil proceedings. Oxfordshire County Council Licence No LA076805

Rev.	Date	Purpose of revision	Drawn	Checked	Approved
0	Aug 13	Original drawing	AG	AG	PT
A	Sept 13	Area	AG	AG	PT
B	Dec 13	Sub Station	AG	AG	PT
C	Mar 14	Sub Station deleted	AG	AG	PT
D	Apr 14	Access license area	AG	AG	GS

OXFORDSHIRE COUNTY COUNCIL
 Mark Kemp
 Deputy Director - Commercial Environment and Economy
 Oxfordshire County Council
 Speedwell House
 Speedwell Street
 Oxford
 OX1 1NE
 Tel: (01865) 815700
 Fax: (01865) 241577

Project title
A415 Ducklington Lane Corridor Highway Improvements

Drawing title
Land Interest Plan Plot 3

Drawing Status: For Information

Scale @ A4	Drawn by	Checked by	Approved by
1/1250	AG	PT	PT
	Date drawn Aug 2013	Date checked Aug 2013	Date approved Dec 2013

PLOT No.	OWNER	LESSEE	OCCUPIER	REQUIREMENT	AREA OF LAND	COLOUR ON PLAN
3	Thames Water Utilities Ltd. Clearwater Court Vastern Road Reading Berks. RG1 8DB			Title	17.0 sq. m.	Pink
3a	As above			License	16.0 sq. m.	Green hatched black
3b	As above			License	50.0 sq. m.	Green hatched black
3c	As above			License	47.0 sq. m.	Green hatched black